

## **HDS Heavy Duty Studreel Instruction Manual**

**\*For Use on 2X4 Stud**



## Table of Contents

Parts List.....	3
Assembly.....	5
Mounting to a Stud.....	7

### Parts List

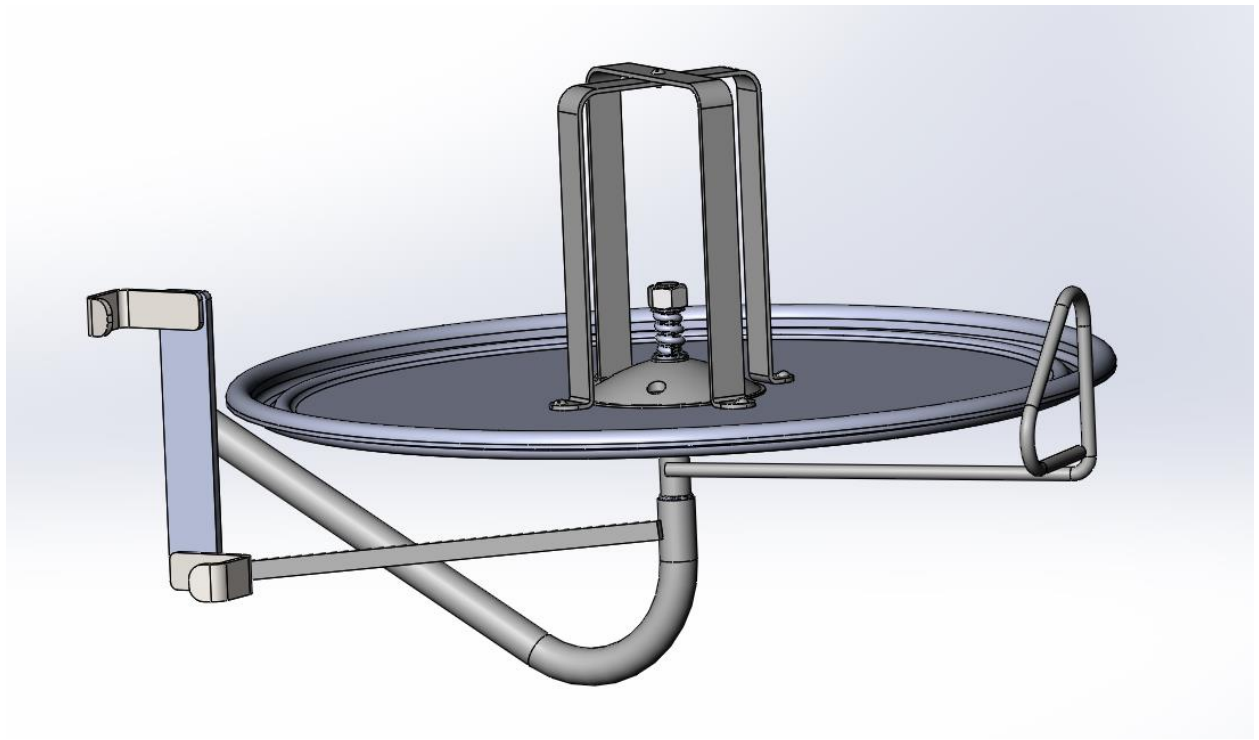
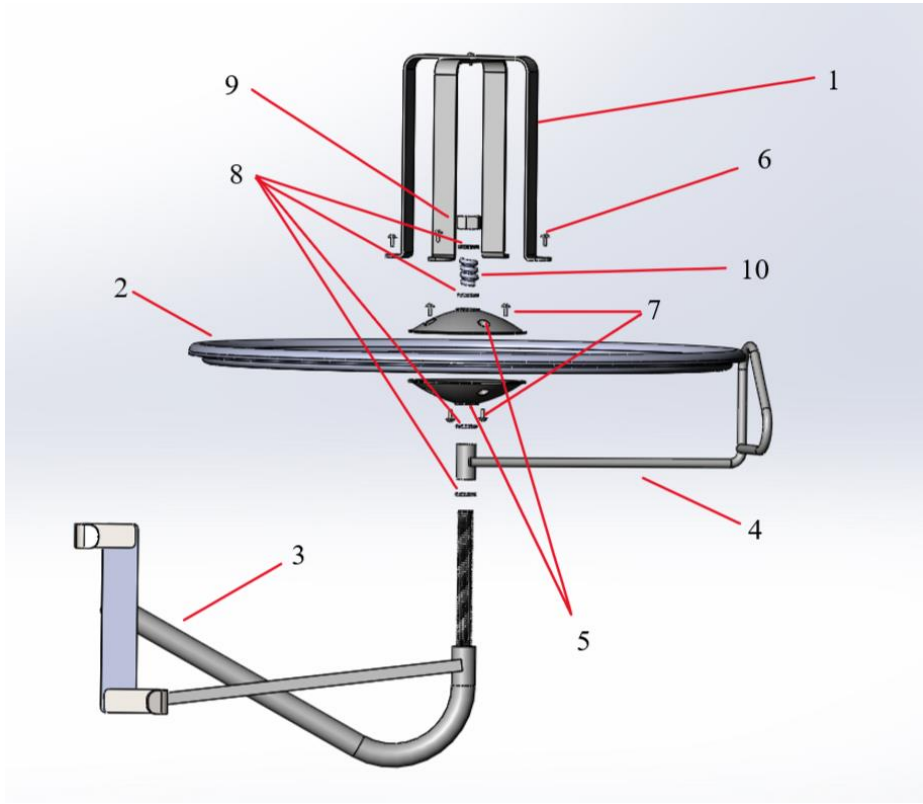

<b>Part Number</b>	<b>Part Name</b>	<b>Quantity</b>
1	Wire Hub Assembly SR-101	1
2	Wire Tray SR-105-E	1
3	Spindle Mounting Weldment SR-108	1
4	Wire Guide Assembly SR-107	1
5	Two Hub Castings SR-105H	1 (2 Castings Total)
6	Four 10-32 Screws & Four 10-32 Lock Nuts SR-106	1 (4 Nuts & 4 Screws Total)
7	Four 10-32 Screws SR-100	1 (4 Screws Total)
8	Four 5/8" Washers SR-103	1 (4 Washers Total)
9	Pressure Nut SR-102	1
10	Pressure Spring SR-104	1

## Assembly

### Attaching the Wire Tray to the Floor Bracket

To attach the wire tray assembly, which includes the wire tray (SR-105-E) and two hub castings (SR-105H), follow the following instructions. Figure 1 below can be used as a visual reference for this process. Slide a 5/8" washer (SR-103), the wire guide assembly (SR-107), another 5/8" washer, the wire tray assembly, a third 5/8" washer, the pressure spring (SR-104) and the final 5/8" washer, and then screw on the pressure nut (SR-102) to secure everything onto the spindle.

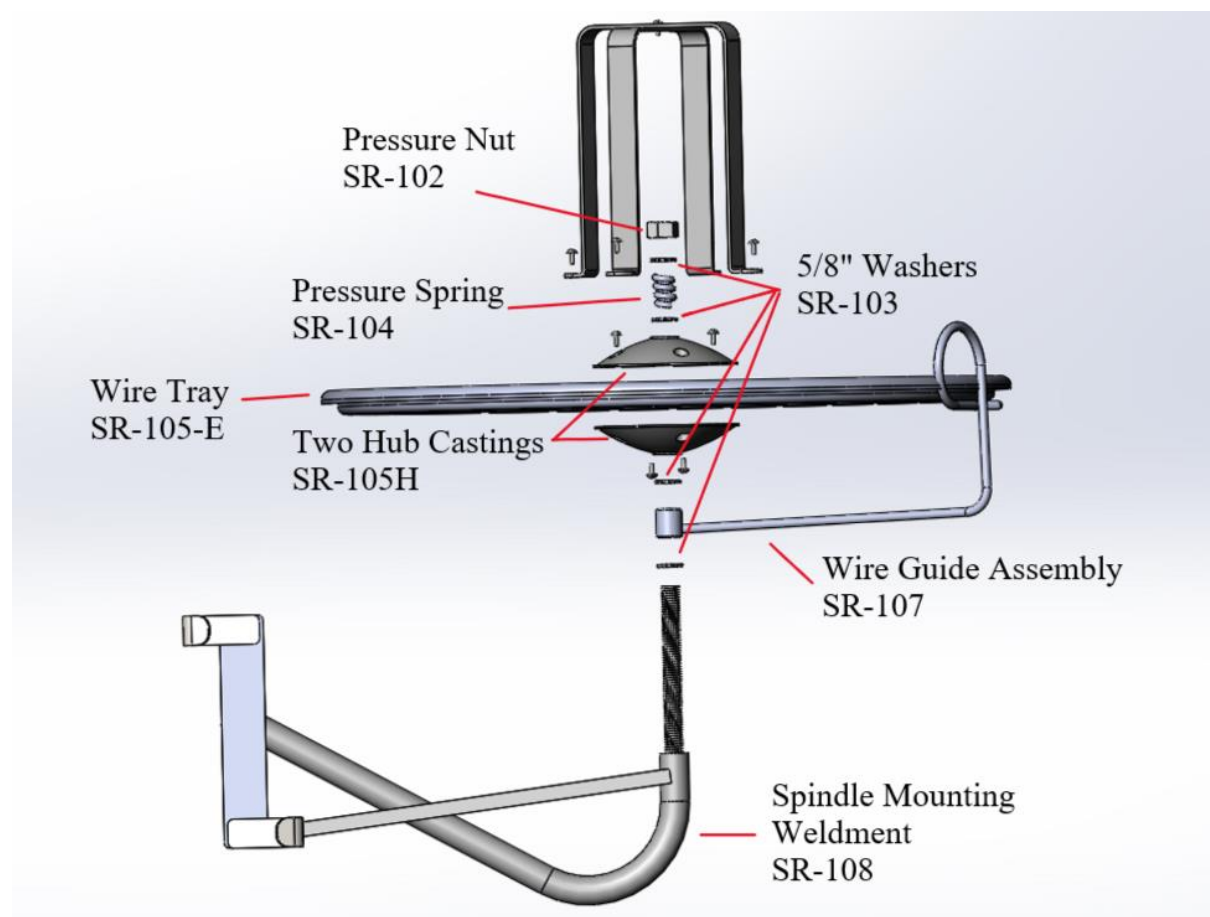

Figure 1  
Attaching wire tray to the spindle mounting weldment. The parts are shown in the correct positions on the spindle mounting weldment.

### Attaching the Wire Hub Assembly to the Wire Tray

To finish assembling heavy duty floor reel, the wire hub assembly (SR-101) needs to be attached to the wire tray. Figure 2 illustrates this process. Also take note that the hub castings (SR-105H) are already attached to the wire tray. First align the holes in the wire hub assembly with the holes in the wire tray. The wire hub assembly may have to flex a little bit to accommodate this. When the holes are aligned, slide the 10-32 screws (SR-106-A) through the holes until they protrude onto the bottom side of the wire tray. Then screw the 10-32 nuts (SR-106-B) onto the 10-32 screws until snug.

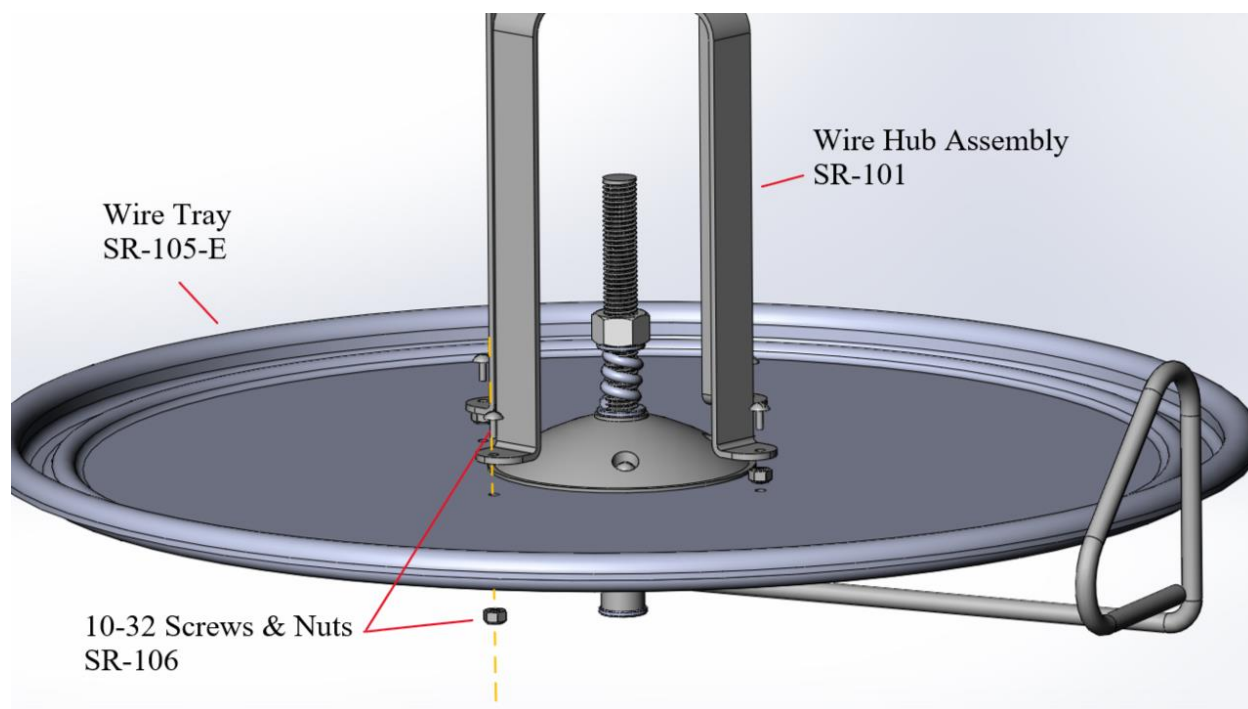

Figure 2  
Attaching the wire hub assembly to the wire tray.

That's all there is to it! The final step is mounting the Heavy Duty Studreel to a stud

## Mounting to a Stud

Now that everything is assembled, it can be mounted to a 2x4. Tilt the stud mount assembly at about a 30° angle as seen in figure 3. Fit the hooks around the stud and rotate the stud mount so that the spindle points directly up.

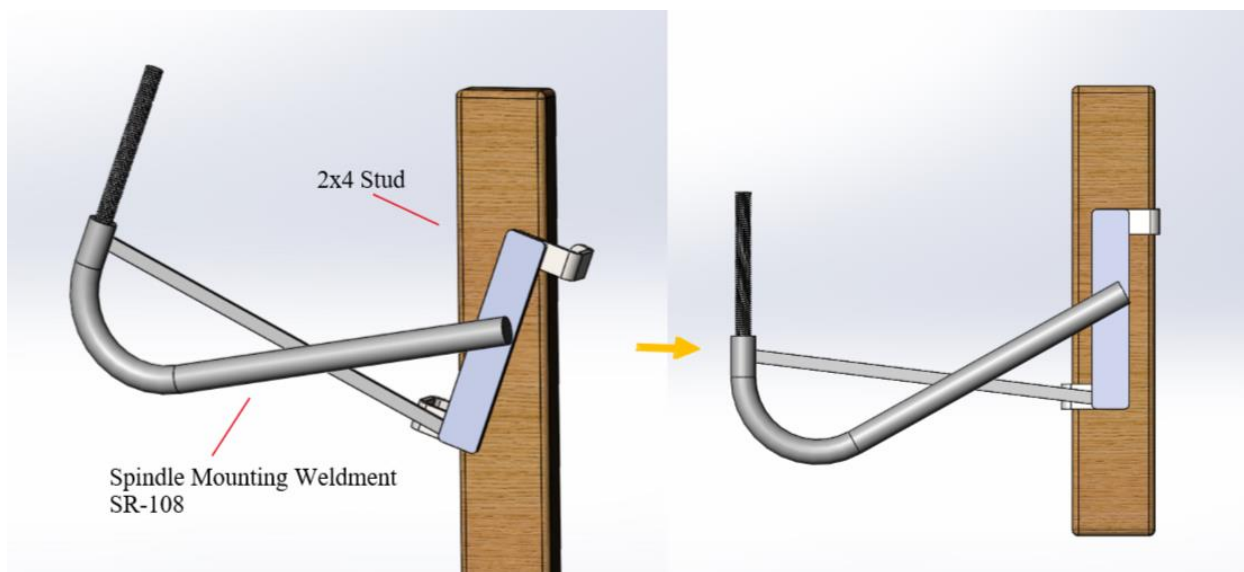

Figure 3  
Mounting the assembly is easy. Just tilt, place and release.

Your Heavy Duty Studreel is now ready to use on any 2x4 stud. Enjoy!